

19m PILOT BOAT

HEAVY DISPLACEMENT • CAMARC DESIGN • PILOT BOATS



VESSEL PARTICULARS

Year Built	2016
Design	Camarc Design
Detailed Design	Mainstay Marine Solutions
Classification	UK MCA Small Commercial Vessel code of practice area category 3, up to 20 miles from a safe haven
Structure	Heavy duty steel all welded construction hull; aluminium superstructure, flexible mounted wheelhouse
Dimensions	Length - 19.7m, Waterline - 17.0m, Beam - 5.7m, Draught - 1.5m
Propulsion	2 x Catapillar C18 in-line 6 cylinder, 4-stroke direct injected, turbo charged after cooled diesel engines, total 670hp at 2100rpm, twin disc MGX5135SC 'Quickshift' gearboxes, Electro-hydraulic steering system, Fixed pitch propellers
Speed	16 knots
Tank Capacities	Fuel 4000litres - Fresh Water 270litres
Navigation Aids	Electronic compass, radar, echosounder, hull transducer, 2 x VHF/DSC radios, GPS, AIS System, electronic chart display, handheld VHF radio, searchlights
Equipment	Anchor windlass; 2 x Catapillar generator sets in acoustic enclosures, 16kVa each at 230Vac 50Hz; wet exhaust system; 'D' section fendering; mooring and anchor handling equipment, 2 x SOLAS approved liferafts
Accommodation	10 x Crew/Pilots. Fitted with heated galley, mess area and WC. Store and workshop area in forward compartment

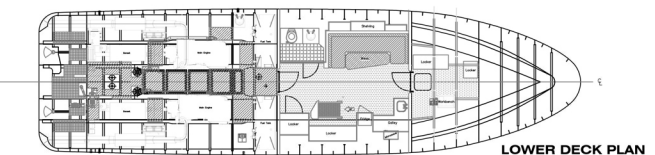
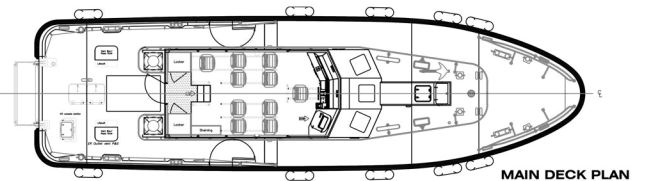
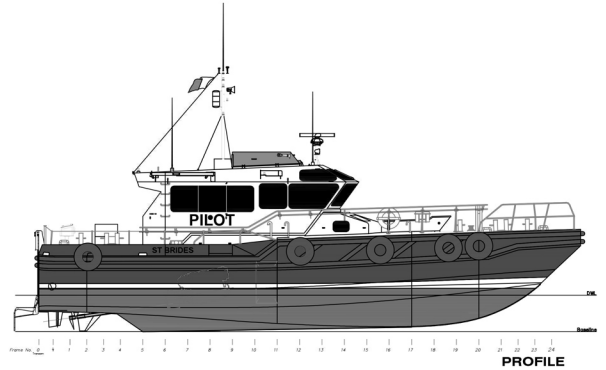

TIME CRITICAL PRECISION

MAINSTAY MARINE SOLUTIONS LIMITED | THE DOCKYARD | PEMBROKE DOCK
PEMBROKESHIRE | SA72 6TE | +44(0)1646681117 | SALES@MAINSTAYMARINE.CO.UK

WORK BOATS
MARINE ENERGY
HARBOUR & JETTY

